

Seymour Johnson AFB - MHPI "710" End-State Potable Water Map

Legend

- Water Anode Test Station
- ◆ Water Fire Connections
- Water Fittings
- ⊗ Water Junctions
- ⊙ Water Meters
- ⊞ Water Pump Station
- ⊠ Water Tank
- ⊞ Water Valves
- main line
- - - abandoned/inactive pipe
- ⋯ building/facility service
- fire protection
- - - Parcel Boundary

NOTE: The PODs shall be the downstream side of the water meter, backflow device, or valve that is closest to the facility. If no meter, backflow device, or valve exists within 25 feet of the facility, the point of demarcation shall be where the utility enters the structure.

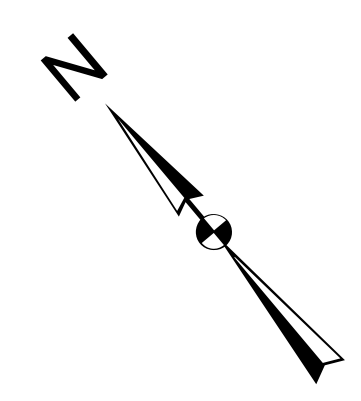
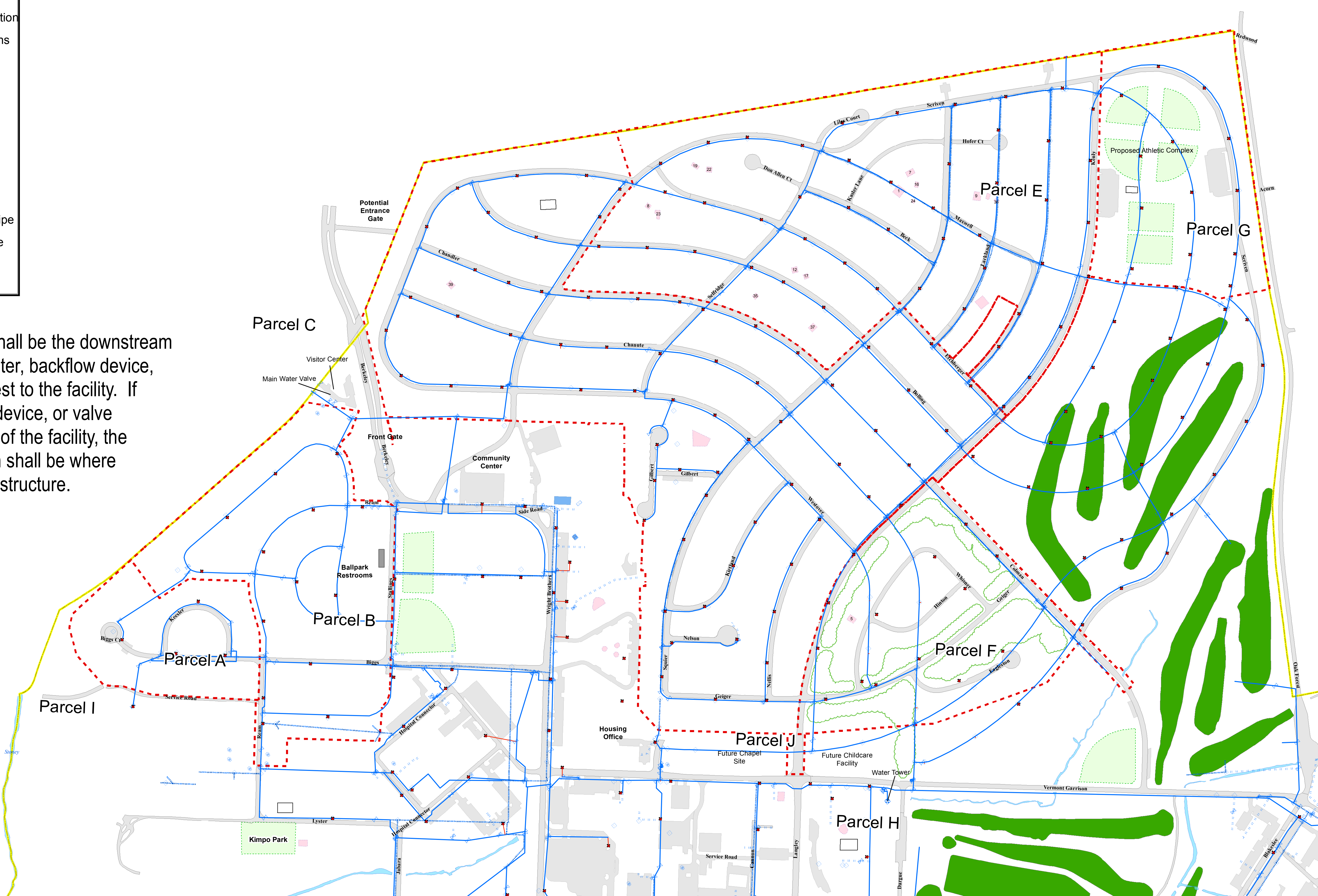

REV	DESCRIPTION	DATE	APPROVD
1			

UNITED STATES AIR FORCE
4TH CIVIL ENGINEER SQUADRON
SEYMOUR JOHNSON AIR FORCE BASE, NORTH CAROLINA

Seymour Johnson AFB

PROJECT TITLE Potablewater.mxd	DATE 18 Aug 2010
DRAWING NUMBER V:\GeoBase\Projects\GIO\Housing	SCALE 1 inch = 300 feet
PROJECT NUMBER	DRAWING SHEET NAME
DESIGNED BY ZJP	DRAWING SHEET NUMBER 1 of 1